



# OUR HOME, OUR LEGACY

## THE CAMPAIGN FOR TKE AT NDSU

Campaign Office ▼ P.O. Box 80828, Atlanta, Georgia 30366 ▼ 607-533-9200

## CASE STATEMENT

### Our Chapter

Tau Kappa Epsilon has been on the grounds at North Dakota State University for over 65 years. We have all been fortunate to be able to watch the chapter grow and to continue as one of the top fraternities at NDSU. We can all be proud of the things that we have accomplished together. Despite this positive history, the brotherhood is concerned with the state of our aging chapter house. Built in two different phases that definitely are different styles, the chapter house at 1131 14<sup>th</sup> St. N is over 50 years old, and the house struggles to meet the needs of our fraternity and members.

With over 65 years in our chapter history, it is an opportunity to reflect on what TKE means to us and what it will mean to the men who follow in our footsteps. With that in mind, we look to the next logical step in our chapter's growth: the conversion of our current house on 14th Street into a state-of-the-art facility that will also bring with it the look of a traditional Greek-style house. Tau Kappa Epsilon has grown and prospered, and now is our opportunity to finish our chapter house to reflect such growth.

### Our Need

Through many decades of use, the property has served as the gathering place for our brothers. Many improvement projects have been completed over the years, including a complete renovation of the chapter/meeting room, dining room, and kitchen in the 2010s. Though this renovation was largely a facelift to the interior of the south side of the house, even those changes have significantly improved living conditions of the brothers.

A myriad of physical issues that have been only temporarily rectified or simply covered up over the past few decades have resurfaced with no easy repair options. The current undergraduate brothers fear that, in coming years, the house will be unsafe: no fire suppression system, a dated electrical system that is taxed with today's electrical usage, a 40-year-old furnace, and cracked foundation walls.

Furthermore, the house does not align with the floor plans, layouts, and expectations of collegiate students, whether that be in campus housing, other fraternities, or the multiple apartment complexes by campus now. With many other fraternities making investments, as well as campus improving and expanding housing, the TKE house has fallen behind.

### Our Goal

The purpose of this campaign is to secure the needed funds to tear down and build a new chapter house and to expand the Delta-Psi legacy for the future generations of Tau Kappa Epsilon at North Dakota State University. The new house will provide living quarters for 25 men; private and public restrooms; handicap accessibility; modern and efficient HVAC, electrical, fire suppression, and plumbing systems; study areas; and a chapter room that every brother will be proud of as it honors our history.

To secure the needed amount of money to ensure financing and a down payment on Delta Psi's house, the campaign needs to raise a total of \$1,800,000. We humbly ask that every brother, parent, and friend of TKE consider a five-year pledge to the campaign. Your commitment will be greatly appreciated. With your support, we will build a house that the members of Delta-Psi can be proud to call their own for generations to come.

DELTA PSI CHAPTER  
OF TAU KAPPA EPSILON  
NORTH DAKOTA STATE UNIVERSITY



# OUR HOME, OUR LEGACY

THE CAMPAIGN FOR TKE AT NDSU

Campaign Office ▼ P.O. Box 80828, Atlanta, Georgia 30366 ▼ 607-533-9200

## TIMELINE

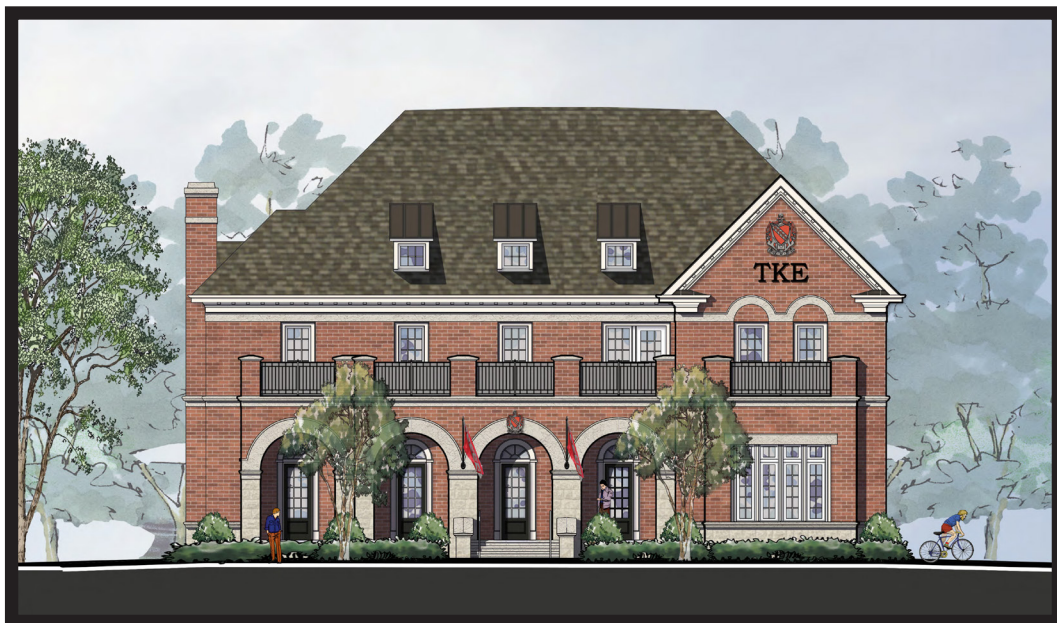
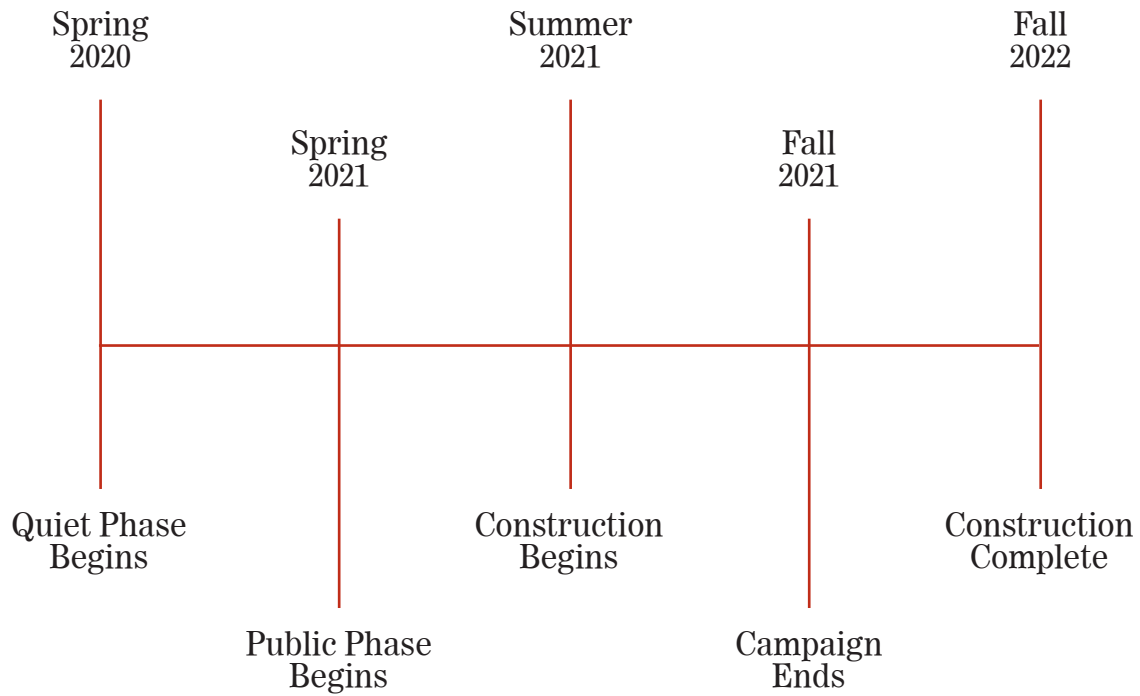

DELTA PSI CHAPTER  
OF TAU KAPPA EPSILON  
NORTH DAKOTA STATE UNIVERSITY



# OUR HOME, OUR LEGACY

THE CAMPAIGN FOR TKE AT NDSU

Campaign Office ▼ P.O. Box 80828, Atlanta, Georgia 30366 ▼ 607-533-9200

## RENDERINGS AND FLOORPLANS

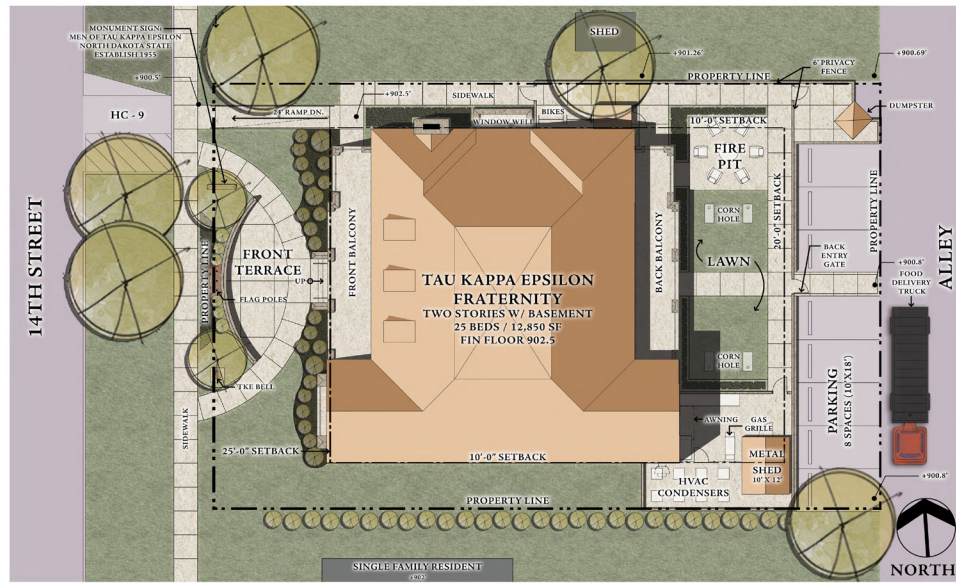

SITE PLAN



BASEMENT LEVEL





## RENDERINGS AND FLOORPLANS (CONTINUED)





### PROJECTS LIST

#### Projected Income

Total Cost: \$3,000,000

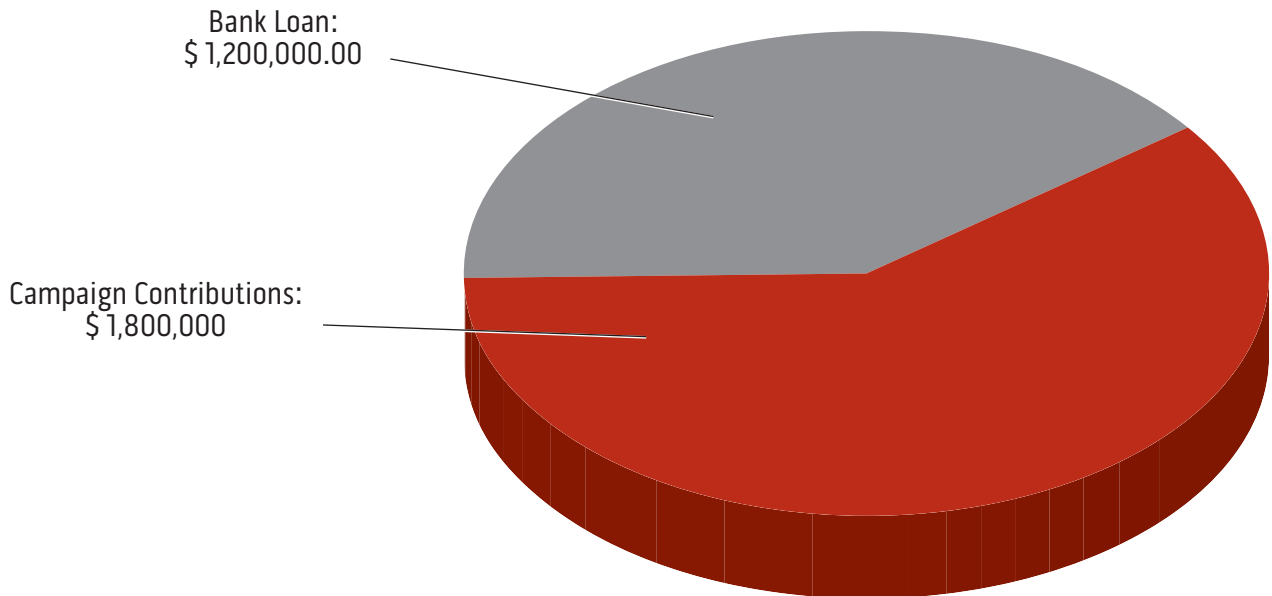

#### Projected Expenses

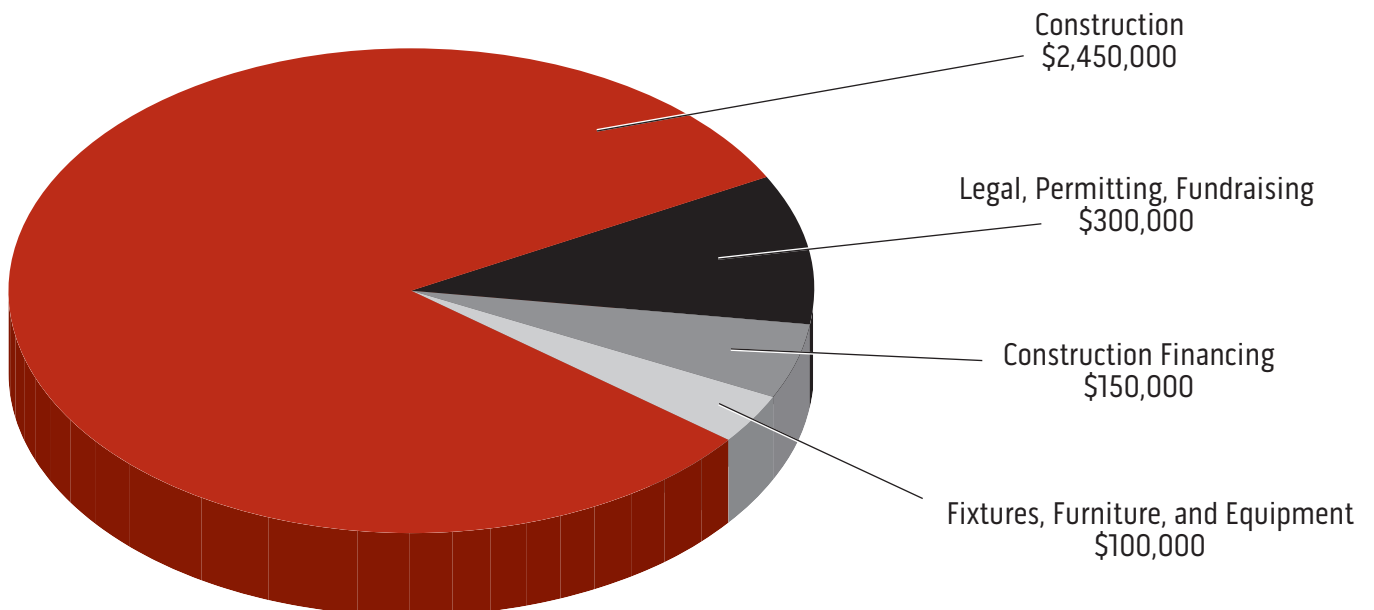



DELTA PSI CHAPTER  
OF TAU KAPPA EPSILON

NORTH DAKOTA STATE UNIVERSITY



# OUR HOME, OUR LEGACY

THE CAMPAIGN FOR TKE AT NDSU

Campaign Office ▼ P.O. Box 80828, Atlanta, Georgia 30366 ▼ 607-533-9200

## LEADERSHIP

### Steering Committee:

Ron Olson '63  
Bruce Kelly '83  
Mark Melby '87  
Loren Tschosik '95  
Aaron Dunn '99

Todd Knain '03  
Travis O'Brien '17  
Bryce Wesely  
*undergraduate representative*

### Building Committee:

Dave Fenelon '89  
Jay Hight '92  
Loren Tschosik '95

Mike Johnson '03  
Todd Knain '03  
Nate Brandenburger '06

### Board of Directors:

Loren Tschosik (#735)  
PRESIDENT  
Dave Fenelon (#687)  
VICE PRESIDENT  
Mark Melby (#634)  
SECRETARY

Todd Knain (#913)  
TREASURER  
Justin Kopp (#896)  
Mark Herrmann (#629)



## DONOR PYRAMID

Campaign Goal: \$1,800,000

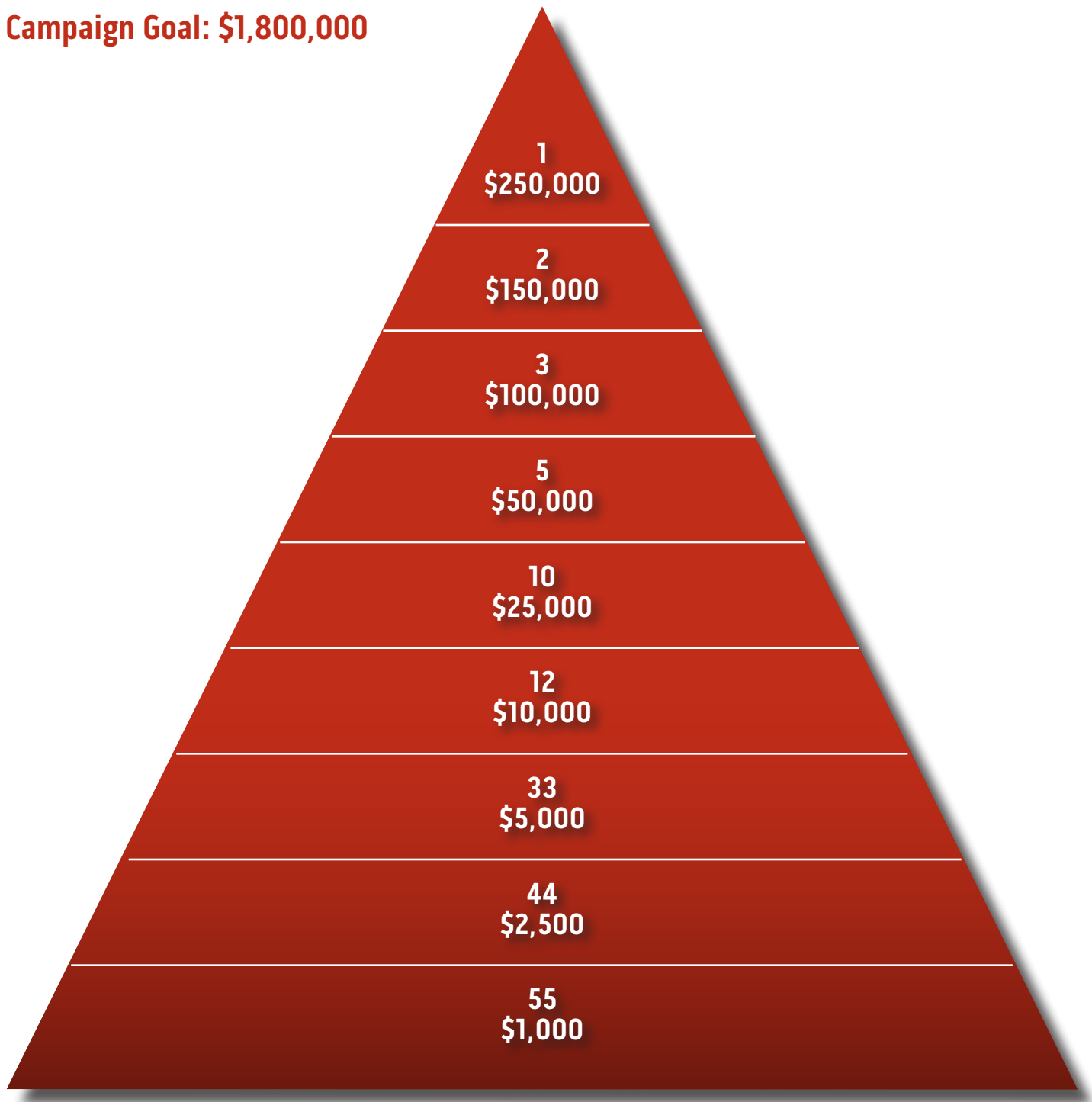



## FREQUENTLY ASKED QUESTIONS

---

### **Why are we conducting a capital campaign to renovate and expand our house?**

Tau Kappa Epsilon just completed its 65th year on the grounds of the North Dakota State University campus. That's no small feat, and we are all proud of the rich history and accomplishments of the chapter. Now is the time to look toward the future. With a new chapter house, we are not only positioning ourselves for the future of the chapter but are also remaining competitive among the other fraternities on campus that have already begun updating and replacing their chapter houses. This capital campaign will ensure that the necessary funds are available to make this project possible.

### **What are the costs associated with the project?**

The total cost for the project is estimated to be \$3,000,000. We have currently set a fundraising goal of \$1,800,000, which will be paired with a bank loan to finance the entire project.

### **How long are pledges to the campaign payable?**

Pledges to the campaign are made over a five-year period. If you desire, you can make your pledge over a shorter period of time, which is welcome because it helps with cash flow and accelerates the project start date. However, we need each brother to make the very best stretch pledge possible over the five-year period. This is our chance to position Tau Kappa Epsilon for the next 65 years on the grounds of NDSU.

### **How can I make a gift?**

Gifts may be made by cash, check, credit/debit card, or stock.

### **My company has a matching gift program; can I apply it to my pledge?**

If your company has a matching gift program, you will receive donor credit for both your pledge amount and the amount of your company's matching gift. Please contact our account manager, Jared Anderson, at [janderson@elevateims.com](mailto:janderson@elevateims.com) or by phone at 607-533-9600 for assistance with this process.

### **Can I make a stock gift?**

You may utilize appreciated stock to fulfill your campaign pledge commitment. If you wish to make this type of gift, please contact our account manager, Jared Anderson. He will be able to assist you with the procedure for this type of pledge commitment.

### **Can I give an in-kind gift to the house?**

In-kind gifts will be reviewed and evaluated on a case-by-case basis by the steering committee.

### **Why now?**

The current house itself is very old, constructed over 50 years ago in two contrasting styles. Although the board and chapter efforts have allowed us to keep the house usable, it has required increasing annual expenditures for repairs and maintenance. Future repairs are at the core infrastructure, not cosmetic in nature. Moreover, while the undergraduate brothers have done an excellent job maintaining a thriving chapter, it's believed that the condition of the house holds the brotherhood back from all it could achieve.



DELTA PSI CHAPTER  
OF TAU KAPPA EPSILON

NORTH DAKOTA STATE UNIVERSITY



# OUR HOME, OUR LEGACY

## THE CAMPAIGN FOR TKE AT NDSU

Campaign Office ▼ P.O. Box 80828, Atlanta, Georgia 30366 ▼ 607-533-9200

## GIVING SOCIETIES

---

### **Knights of a Lasting Legacy**

\$500,000 or more

### **Society of 1899**

\$250,000–\$499,999

### **Grand Prytanis' Circle**

\$100,000–\$249,999

### **Presidents Circle**

\$50,000–\$99,999

### **Leaders Circle**

\$25,000–\$49,999

### **Merv Nordeng Society**

\$10,000–\$24,999

### **Triangle Society**

\$5,000–\$9,999

### **Founders Club**

\$2,500–\$4,999

### **Love, Charity, Esteem Club**

\$1,500–\$2,499

### **Bison Club**

\$600–\$1,499

### **Fraters Club**

\$599 and under



# OUR HOME, OUR LEGACY

## THE CAMPAIGN FOR TKE AT NDSU

Campaign Office ▼ P.O. Box 80828, Atlanta, Georgia 30366 ▼ 607-533-9200

## HOW CAN YOU GIVE BACK TO DELTA PSI?

### Tax-Deductible Pledge Samples

Tax-deductible pledges (pledges \$25,000 and greater over five years) will be paid to the Tau Kappa Epsilon Foundation. These gifts will be utilized for all construction costs associated with educational space in the new house. Below are examples of how a tax deductible pledge breaks down over a five year period.

5 Year Pledge Amount	Monthly	Quarterly	Semi-Annually	Annually	After-tax pledge amount (presuming a 40% combined state and federal tax rate)
\$25,000	\$416.66	\$1,250	\$2,500	\$5,000	\$15,000
\$50,000	\$833.33	\$2,500	\$5,000	\$10,000	\$30,000
\$100,000	\$1,666.66	\$5,000	\$10,000	\$20,000	\$60,000
\$250,000	\$4,166.67	\$12,500	\$25,000	\$50,000	\$150,000

### Non-Deductible Pledge Samples

Non-deductible pledges (pledges less than \$25,000 over five years) will be paid to Tau Kappa Epsilon of NDSU. These gifts will be utilized for all construction costs not associated with educational space, as well as furniture, appliances, and other interior decor for the renovated/expanded house and an endowment/maintenance pool. Below are some examples of how a non-deductible pledge breaks down over a five year period.

5 Year Pledge Amount	Monthly	Quarterly	Semi-Annually	Annually
\$1,000	\$16.67	\$50	\$100	\$200
\$2,500	\$41.66	\$125	\$250	\$500
\$5,000	\$83.33	\$250	\$500	\$1,000
\$10,000	\$166.66	\$500	\$1,000	\$2,000
\$15,000	\$250.00	\$750	\$1,500	\$3,000



## ROOM NAMING GUIDELINES

The Steering Committee reserves the right to approve all room naming requests.

Room naming opportunities are available based on the date a pledge is confirmed. Therefore, please list your **top three choices in order of priority**.

There will be a plaque placed inside or at the entrance to each naming area, as determined by the Campaign steering committee. The plaques will be placed so that they are easily seen.

Names on plaques should be kept to a maximum of 24 letters and must be approved by the steering committee.

### Room Plaque Examples

*In Honor of John Doe Smith '94  
(living or deceased) \* by Mister  
Smith '96*

*In Memory of John Doe Smith '94  
(deceased only) \**

*The John Doe Smith Study Room*

*The Doe Family Living Room*

*The Smith Family Dining Room*

*The Class of 1989 Room*

***\*Initiation year will be used  
after the alumni's name.***



Room Naming Opportunities	Price / Each	Max Donors*
Overall House	\$1,000,000	1
Each Floor/Level (3 floors available)	\$250,000	2
Chapter Meeting Room	\$250,000	2
Dining Room	\$100,000	4
President's Suite	\$50,000	1
Living Room	\$50,000	5
Study/Conference	\$50,000	5
Kitchen	\$50,000	2
Upstairs Lounge/TV Room	\$50,000	5
Front or Back Porch (2 available)	\$50,000	2
Serving Area/Weekend Kitchenette	\$25,000	5
Foyer	\$25,000	1
Study Lounge	\$25,000	1
Study/Meeting (2 available)	\$20,000	2
Quiet Study (1 available)	\$20,000	2
Triple Bedroom (2 available)	\$30,000	3
Single Bedrooms (2 available)	\$20,000	1
Double Bedroom (8 available)	\$10,000	2
Billiards/Ping-Pong Room	\$25,000	1
Fire Pit	\$10,000	1

\*Maximum number of donors that can group together for a single naming.





## ROOM NAMING RANKINGS

---

Based on the Naming Right guidelines and opportunities, please complete the following:

Name: \_\_\_\_\_

Date: \_\_\_\_\_

### TOP 3 CHOICES IN ORDER OF PRIORITY

Please provide room number as listed on floor plan. The steering committee will do their best to accommodate your top choices.

1. \_\_\_\_\_

2. \_\_\_\_\_

3. \_\_\_\_\_

### NAME OF ROOM

Please indicate how you would like it to appear on the plaque, pending final approval by the steering committee.

\_\_\_\_\_

Please note that house plans are subject to change and room naming order will be based on the date of your pledge and will follow a “first come, first served” basis.

If you have any questions about room selections, please contact Jared Anderson, account manager, at 607-533-9200 or [janderson@elevateims.com](mailto:janderson@elevateims.com).